



HYDRACELL Aqua Tac Flashlight User Guide

The HydraCell AquaFlash Flashlight operates on electricity produced by an HC1D HydraCell. Cell is shipped sealed & dry and can be stored for 25+ years prior to initial activation. Cell becomes activated when dipped in water. Follow these steps to activate and use the AquaFlash Flashlight.

ACTIVATING the AquaFlash Flashlight



Remove HC1D HydraCell from plastic sealing. Immerse cell fully in water for 15 seconds.

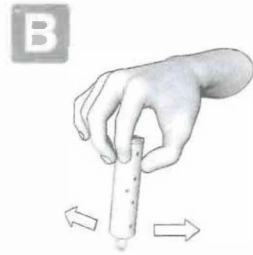

Shake off excess water. * **IMPORTANT** * Thoroughly wipe contact end of cell with a dry cloth, making sure metal cell contacts are clean & dry.



Remove threaded rear section of AquaFlash by rotating counterclockwise. Place aside.

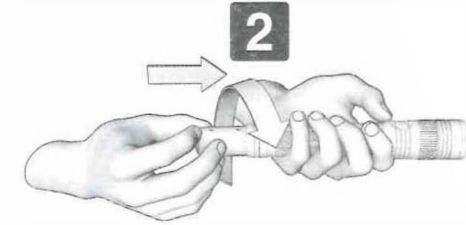

Cell fits snugly in AquaFlash barrel. Use a twisting motion to fully insert activated cell, confirming cell is properly seated. Replace rear section, making sure rear section is properly threaded on.

REPLACING or REHYDRATING the HydraCell in the AquaFlash Flashlight

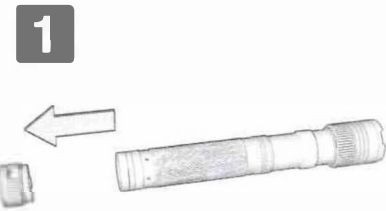

Remove threaded rear section of AquaFlash by rotating counterclockwise. Place aside.

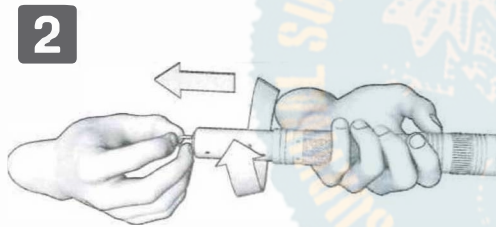

Using provided finger handle on cell end, remove used cell by pulling cell out with a twisting motion.



Follow steps **A** **B** above to activate new cells or rehydrate current ones

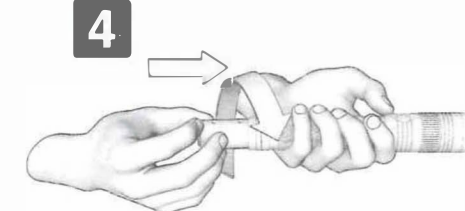

Use a twisting motion to fully insert new or rehydrated cell. Make sure cell contacts are clean & dry. Confirm cell is properly seated, then replace rear section, making sure rear section is properly threaded on.

OPERATING the AquaFlash Flashlight



CAUTIONS:

- When activating new cells, immerse cells fully in water for 15 seconds. * **IMPORTANT** * Before inserting cells, make sure metal cell contacts are clean & dry.
- Before using make sure cell is fully inserted and properly seated and that rear section is securely threaded on.
- To maintain full power output, cells should be periodically re-hydrated.
- After several cell dippings or if light brightness diminishes, cells may be reconditioned and brought back to full power by dipping in hot water.
- Do not dip cells in any other liquid than plain or salt water.
- Any residue that appears on surfaces is harmless and can be wiped clean with a damp cloth.
- Front electronics compartment contains no user serviceable components. Do not try to open or disassemble.
- Used cells are non-toxic and may be safely disposed of or recycled.